

## 7' 6" Spindle & Blade Assembly

Ref.#	Qty	Part #	Description
1	1	6343K19	Bearing Nut
2	1	6343K999	Spider Washer
3	1		3/16" Key stock, 1/2"long
4	1		Collar, Seal Bushings (for spindles)
5	2	472653-NAT	Oil seal 2.000 x 2.835 <b>(2021 and later)</b>
5	2	470543-NAT	Oil seal 2.000 x 2.717 <b>(2020 and before)</b>
6	2	14137A	Bearing Cone
7	2	14276-TIM	Tapered Roller Cup. <b>Race</b>
8	1	1093K1	Grease pressure release valve
9	1	1610-BL	Grease Zerk
10	1	5503X0202	45 Degree Elbow
11	6	H8F916X2	9/16-18 X 2, Hex Bolt, Grade 8
12	6	NF916G8	9/16-18 Nut, Grade 8
13	1	4386	Mower Hub
14	1	4387	Mower Spindle
15	2	Left Turn	LH Blade to fit Lilliston, <b>Belt to Engine Drive</b>
15	2	Right Turn	RH Blade to fit Lilliston, <b>For PTO Driven</b>
16	2		1/2" X 2 <b>(Grade 2)</b> Shear bolts
17	2		3/4" X 2 1/2" Flathead Cap Screws
18	2		1/2" Nylon Lock Nuts
19	2		3/4" Steel Locknuts
20	1		2-1/2" X 7" Steel Plate

### Installation Tips

- Do not lose 3/16" X 1/2" Key. If key is missing nut will not stay tight.
- Press race and seal against their seat.
- Make sure nut is tight enough that spider washer cannot move. Then clinch washer tab onto nut. **See diagram below. #2**
- Fill hub with grease until it comes out of grease valve. **Keep it full during use.**

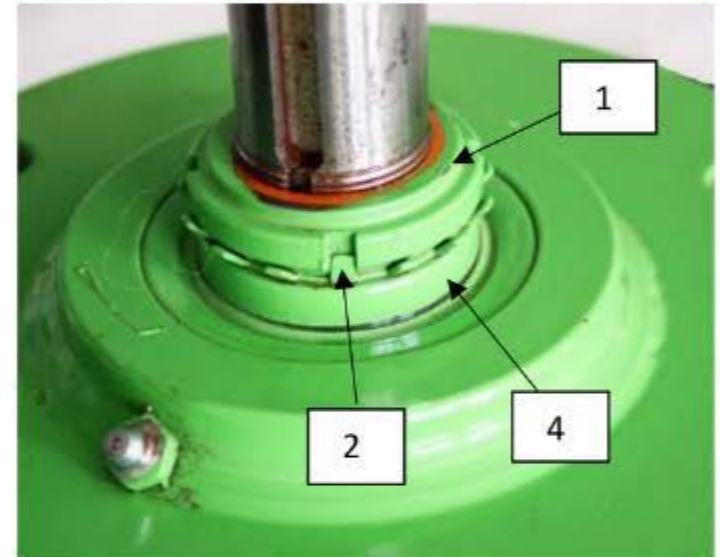

# Hub Assembly

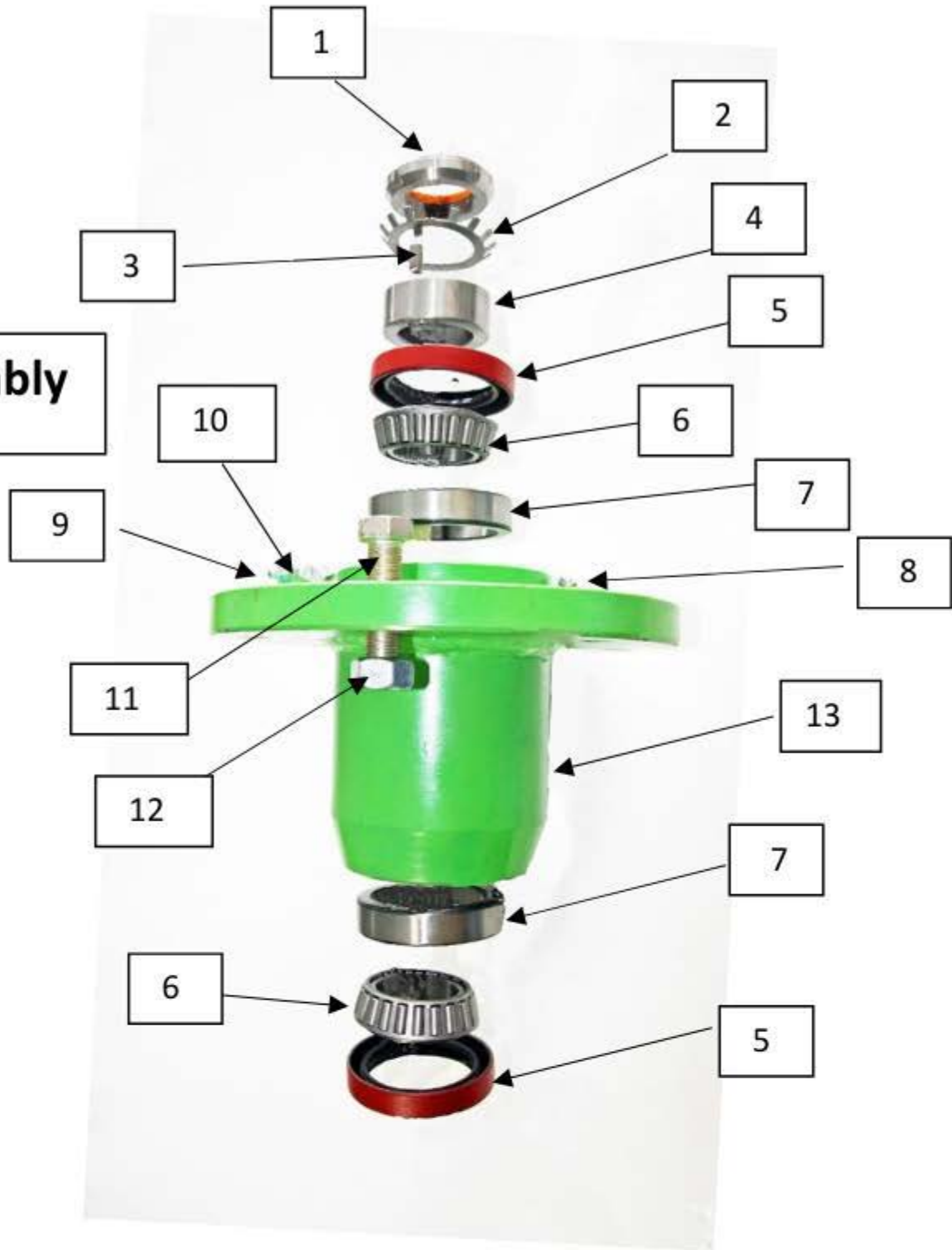

# Spindle Assembly

